

ALL-PRO® 5 DECUM

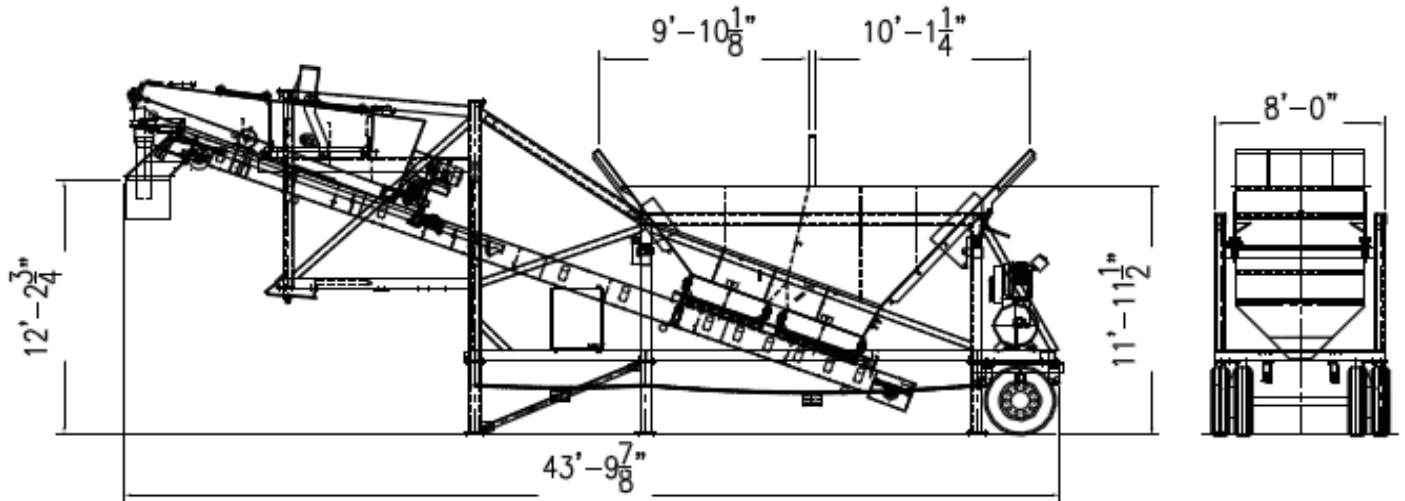

SPECIFICATIONS

PRODUCTION CAPACITY:

Theoretical Cycle Time - 2.5 to 3 minutes

BATCHER CAPACITY:

Aggregate - 563 cubic yards (15.9 cubic meters)
Cement - 1 to 6 cubic yards (1 to 4.5 cubic meters)
Scales - Direct Load Cells

AGGREGATE DISCHARGE CONVEYOR:

24" wide (610 mm), 10 horsepower drive. Optional
30" (762 mm), 10 horsepower

CEMENT BATCHER RECIRCULATING SCREW:

12" diameter (305 mm), 10 horsepower

HIGH PRESSURE AIR COMPRESSOR:

5 horsepower, 80 gallon (0.30 cubic meters). Optional 10 horsepower,
80 gallon (0.30 cubic meters).

ELECTRICAL:

460 volt, 3-phase with 120 VAC transformer for control voltage. All
motors are TEFC. All motor circuit wiring protected by individual circuit
breakers. Electrical components housed in NEMA steel enclosures.
Wiring in conduit.

BATCH CONTROL SYSTEM:

Semi-automatic cut-off of cement by presets on digital readouts. Push-
button for electric over air on gates. Optional fully automatic comput-
erized batch control system.

WATER METER:

3" diameter (77 mm) with up to 500 gallons (1,740 liters) per minute.

CEMENT FEEDER SCREW CONVEYOR:

6" diameter (152 mm), 10 horsepower drive x 25'-0" (7,620 mm)
long, includes 4'-0" x 4'-0" receiving hopper.

TRANSPORTATION SYSTEM:

Rear-mounted 19,000 lb. (9,090 kg) capacity single axle with four (4)
295/75R 22.5 tires, wheels, air brakes heavy duty spring suspension, tail
and brake lights, and fifth wheel rub plant with king pin.

STORAGE BIN CAPACITIES:

AGGREGATE	HEAPED VOLUME
	12 to 31 cubic yards
	9 to 24 cubic yards
CEMENT I	GROSS VOLUME
	1,600 cubic feet
	45 cubic meters

DIMENSIONS: (plant only, no silo)

Towing length.....	37'-6" (11,431 mm)
Towing height.....	14'-4" (4,268 mm)
Towing width.....	8'-0" (2,440 mm)
Empty weight, total.....	30,000 lbs. (13,608 kg)

SHIPPING DIMENSIONS: (plant only, no silo)

Length	44'-0" (13,411 mm)
Height	14'-4" (4,268 mm)
Width	8'-0" (2,440 mm)
Shipping Volume	4,928 cubic feet (140 cubic meters)